

Sparkes Close, Bromley | £1,550 PCM



A large top floor 2 bedroom apartment to rent in bromley very close to Bromley South Station. Offering just under 1000 sq ft of living space. Offering 2 balconies and 2 car parking spaces the flat has a huge living/dining room as well 2 good sized double bedrooms each with their own bathroom.

With wood flooring running through the main living space the flat has modern fitted kitchen with appliances and has lots of natural light running through it.

Available to move into from mid January, this will suit 2 professional sharers that want to ideally walk to Bromley South Station and commute into London without any fuss.

Contact us quickly to arrange a viewing before this one gets snapped up.



Energy Efficiency Rating

Current

Potential

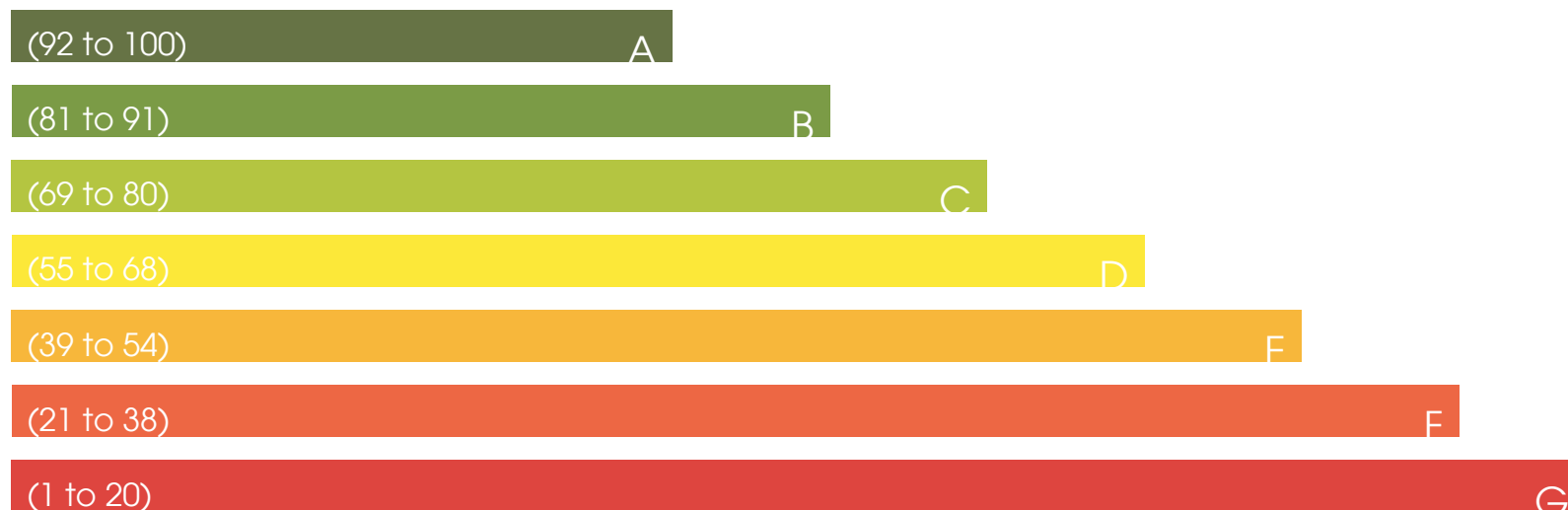

Enviromental Impact (C0₂) Rating

Current

Potential

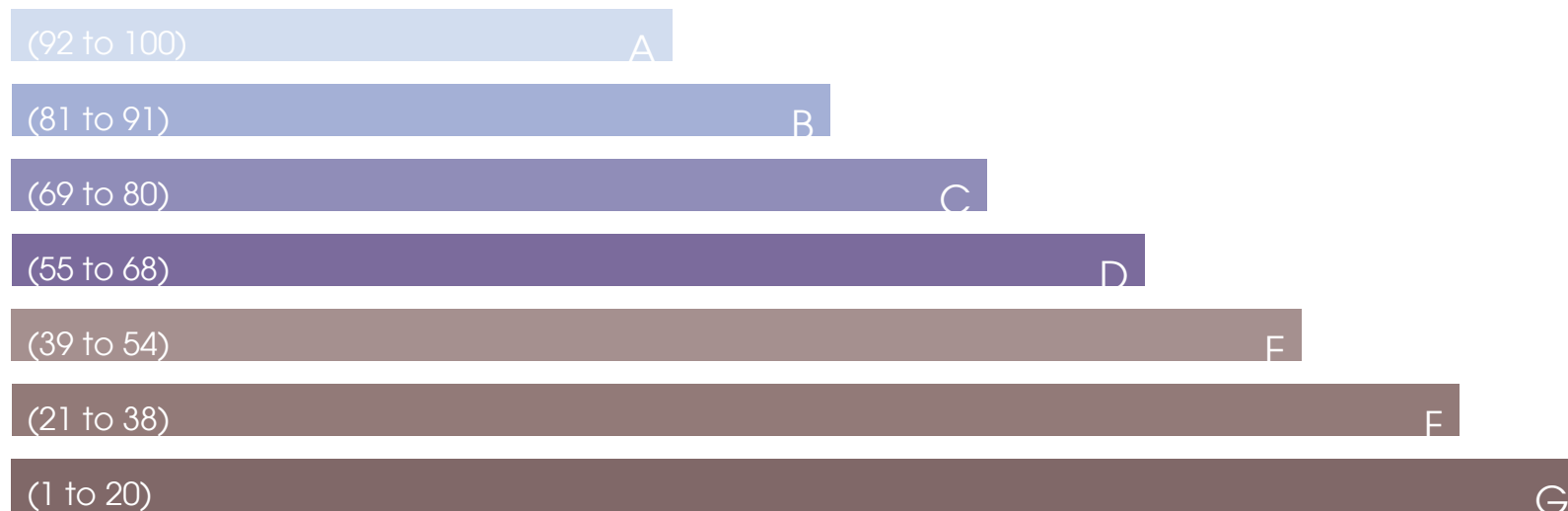

●●● bromley property company

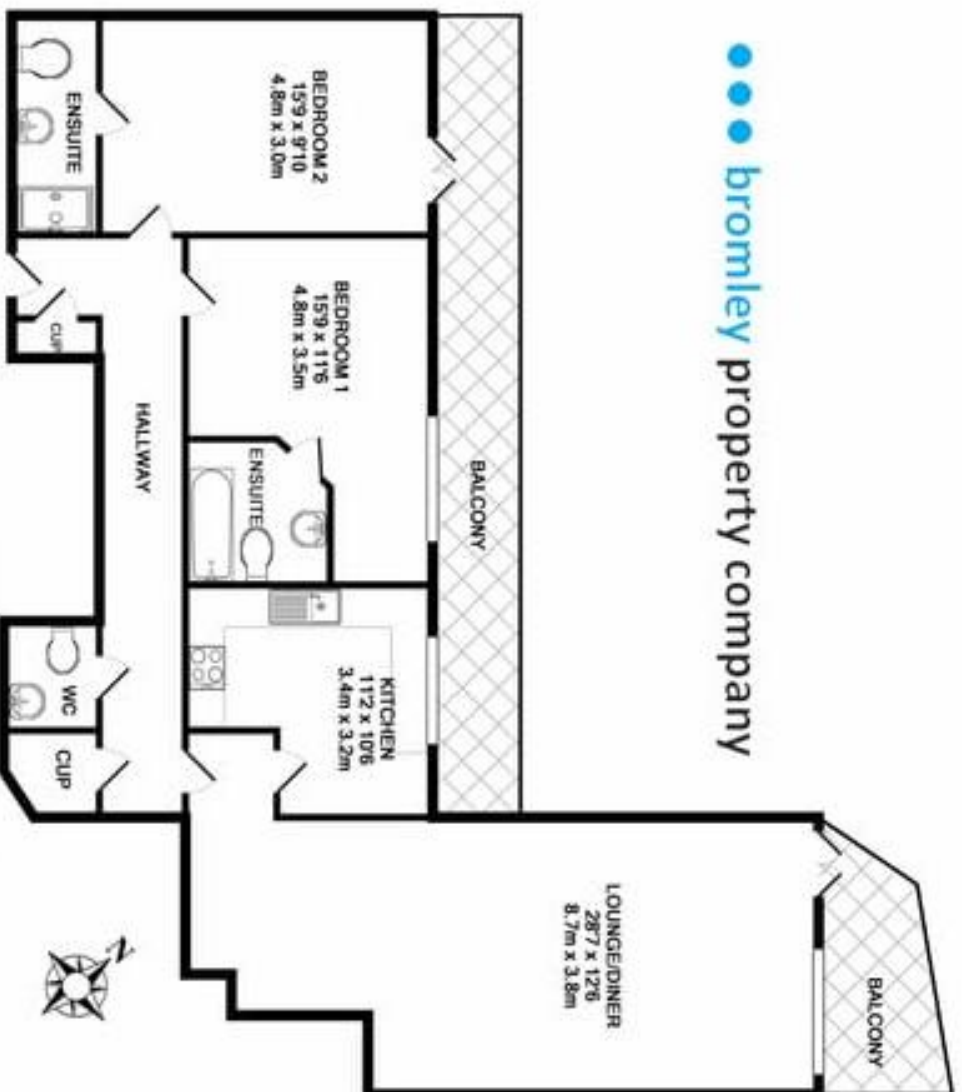

TOTAL APPROX. FLOOR AREA 968 SQ.FT. (89.9 SQ.M.)

While every attempt has been made to ensure the accuracy of the floor plan contained herein, measurements of doors, windows, rooms and any other items are approximate and no responsibility is taken for any error, omission, or misstatement. This plan is for illustrative purposes only and should be used as such by any prospective purchaser. The services, systems and appliances shown have not been tested and no guarantee as to their operability or efficiency can be given.

Made with Mapbox (2018)