

Newbury Road, Bromley | £1,550 PCM



Available 20th September 2019.

This charming 2 bedroom cottage is located within a few minutes walk from Bromley South station and the High Street.

Decorated and finished to a very high standard, the house is ideal for a professional couple or single person.

Oozing with character you enter into the house and find a dining room that leads onto a modern fitted kitchen and past that into a downstairs shower room. To the front of the house is a good sized sitting room and upstairs there are 2 double bedrooms, the master of which has a stunning en-suite bathroom.

The garden has been well cared for and although isn't lawned is ideal for someone that has an interest in enjoying and looking after a nice area of outside space.

Available to move into from mid November the house should tick the boxes for lots of people looking for a well maintained house that's located close to transport links and a bit of nightlife.



Energy Efficiency Rating

Current

Potential

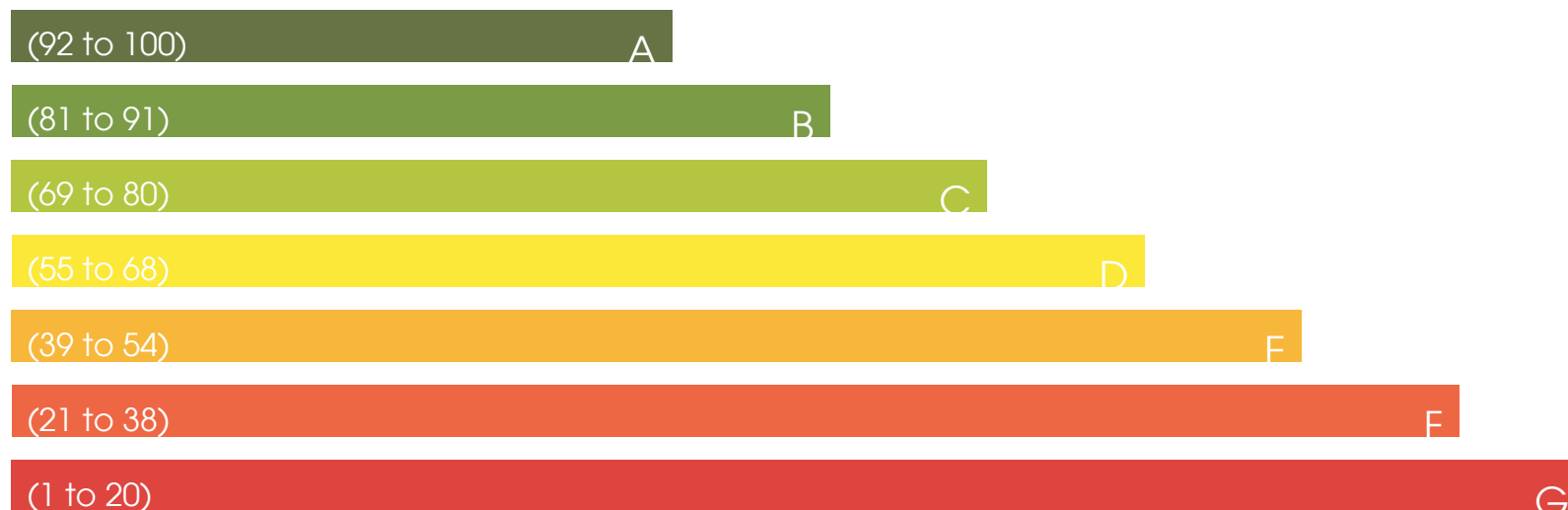

Enviromental Impact (C0₂) Rating

Current

Potential

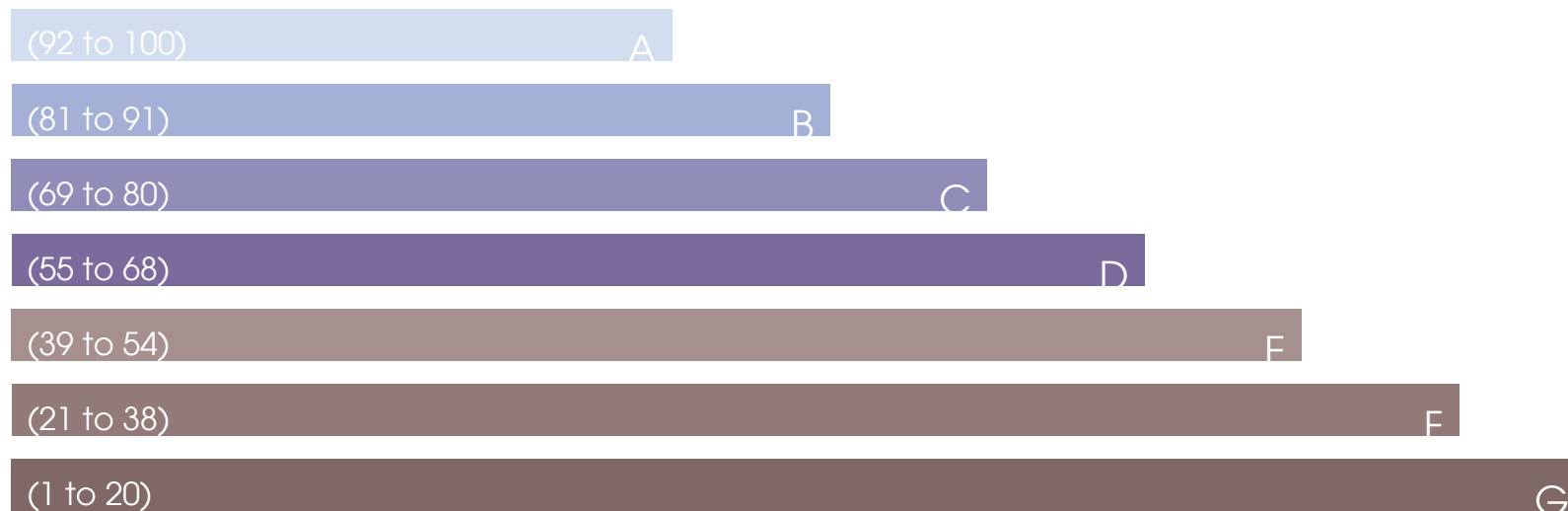

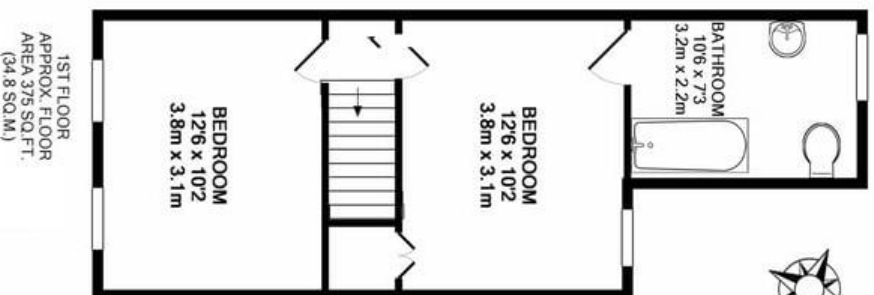
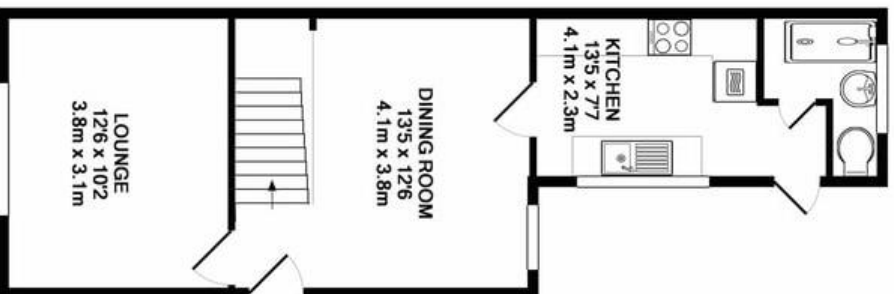

●●● bromley property company

TOTAL APPROX. FLOOR AREA 788 SQ.FT. (73.2 SQ.M.)

Whilst every attempt has been made to ensure the accuracy of the floor plan contained here, measurements of doors, windows, rooms and any other items are approximate and no responsibility is taken for any error, omission, or mis-statement. This plan is for illustrative purposes only and should be used as such by any prospective purchaser. The services, systems and appliances shown have not been tested and no guarantee as to their operability or efficiency can be given

Made with Metropix ©2017