

Pope Road, Bromley | £2,200 PCM



Available unfurnished from 20 January 2022.

This stunning 5 bedroom modern house is located in Chatterton Village and is available immediately.

The house is in great condition and set out over 3 levels.

On the ground floor there is a kitchen diner to the front of the property and a living room to the rear that leads out to a well kept private garden as well as a downstairs WC.

Upstairs and there are 2 double bedrooms and a single on the first floor, the master having an en-suite bathroom as well as a family bathroom.

Up again to the top floor and there are 2 more double bedrooms.

There is off street parking on the driveway for 1 car.

Bromley town centre and Train station is a 15 minute walk or 5 minute bus ride.

No pets allowed.



Energy Efficiency Rating

Current Potential

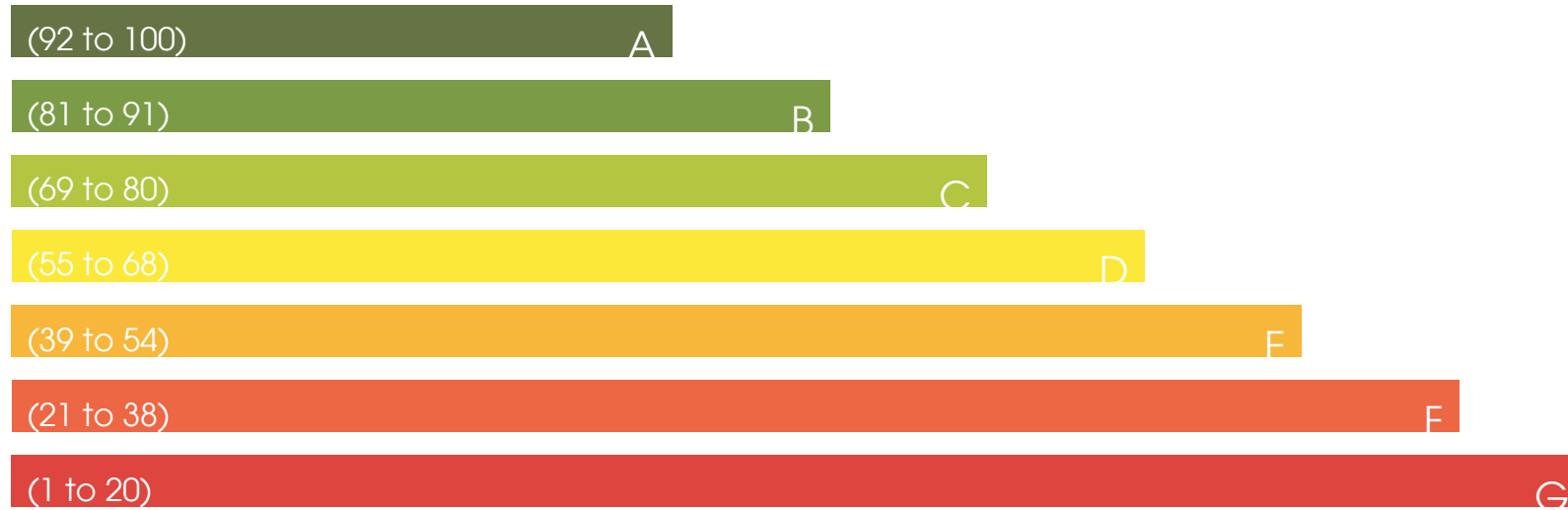

Environmental Impact (CO₂) Rating

Current Potential

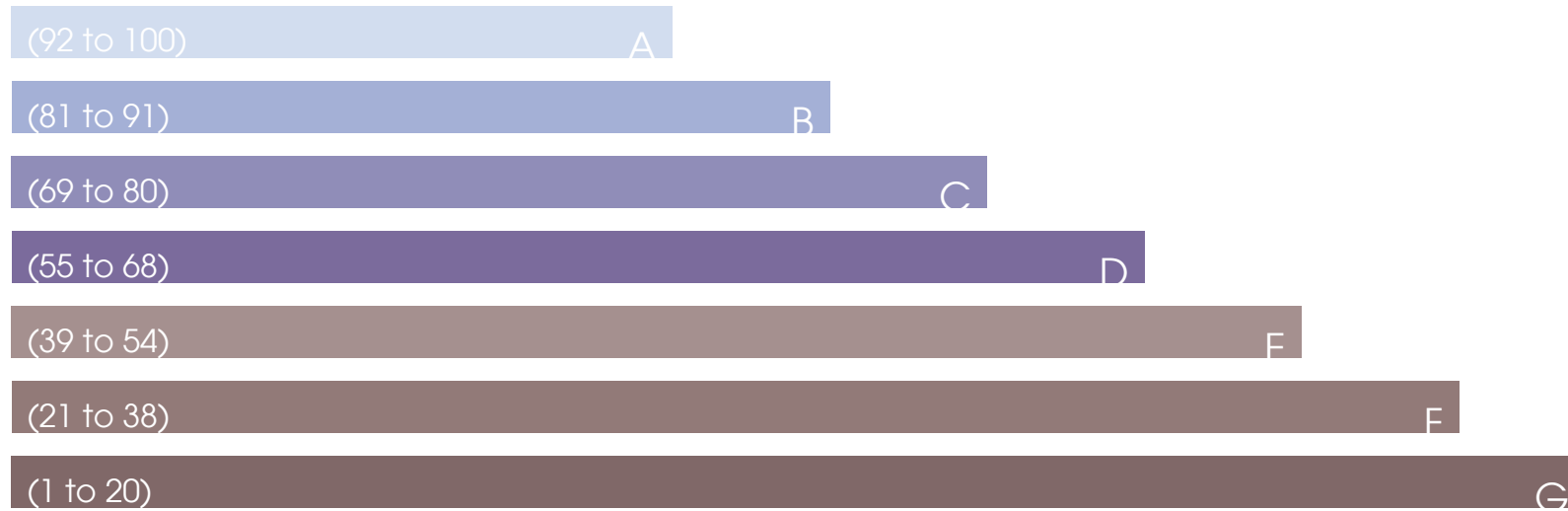

GROUND FLOOR
404 sq. ft. (37.5 sq. m.) approx.

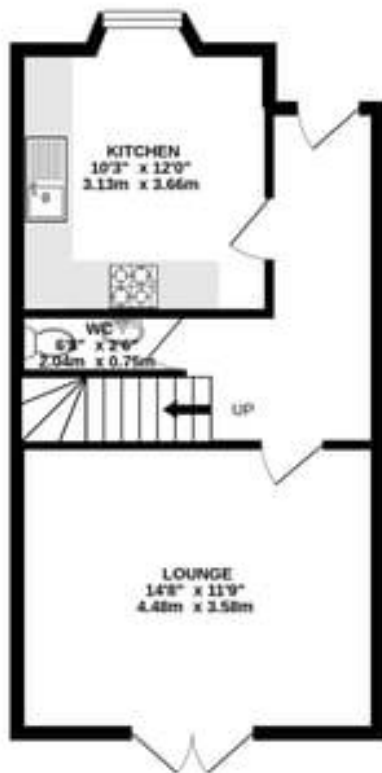

1ST FLOOR
415 sq. ft. (38.5 sq. m.) approx.

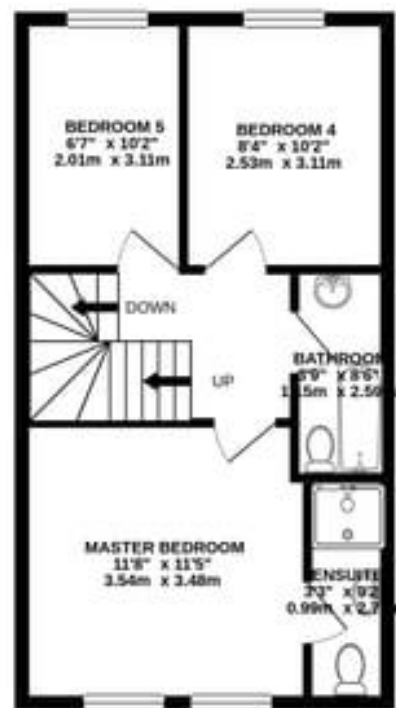

2ND FLOOR
321 sq. ft. (29.8 sq. m.) approx.

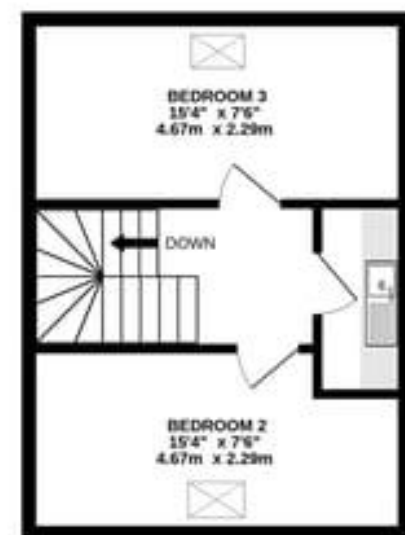

••• bromley property company

TOTAL FLOOR AREA : 1139 sq ft. (105.8 sq. m.) approx.

Whilst every attempt has been made to ensure the accuracy of the floorplan contained here, measurements of doors, windows, rooms and any other items are approximate and no responsibility is taken for any error, omission or mis-statement. This plan is for illustrative purposes only and should be used as such by any prospective purchaser. The services, systems and appliances shown have not been tested and no guarantee as to their operability or efficiency can be given.
Made with Metropix ©2021