

The Green, Bromley | £1,150,000



This fabulous extended 4/5 bedroom semi detached house offering over 3000 sq ft of living space is finished immaculately and located within catchment for Hayes Secondary School and within walking distance of Hayes high Street and Train Station.

The house has great natural light running throughout it and has a good size living room to the front of the property. To the rear there is a wonderful open plan high spec kitchen and dining area as well as a second reception/snug area. Bifold doors lead out to the beautiful low maintenance garden that has a large patio and entertaining area as well as a Home office/Summer house.

There is also separate WC and a utility room as well as a study that could also be a guest/5th bedroom.

Upstairs and there are 3 large double bedrooms, the huge master having a walk in wardrobe and en-suite shower room as well as a large family bathroom.

Up again to the converted loft and there is another large double bedroom with an en-suite bathroom as well as 2 large eves storage areas.

The house is set in a very quiet location and is one of the best houses we've seen in a long while.

Contact us to arrange a viewing at your earliest convenience.



Energy Efficiency Rating

Current

Potential

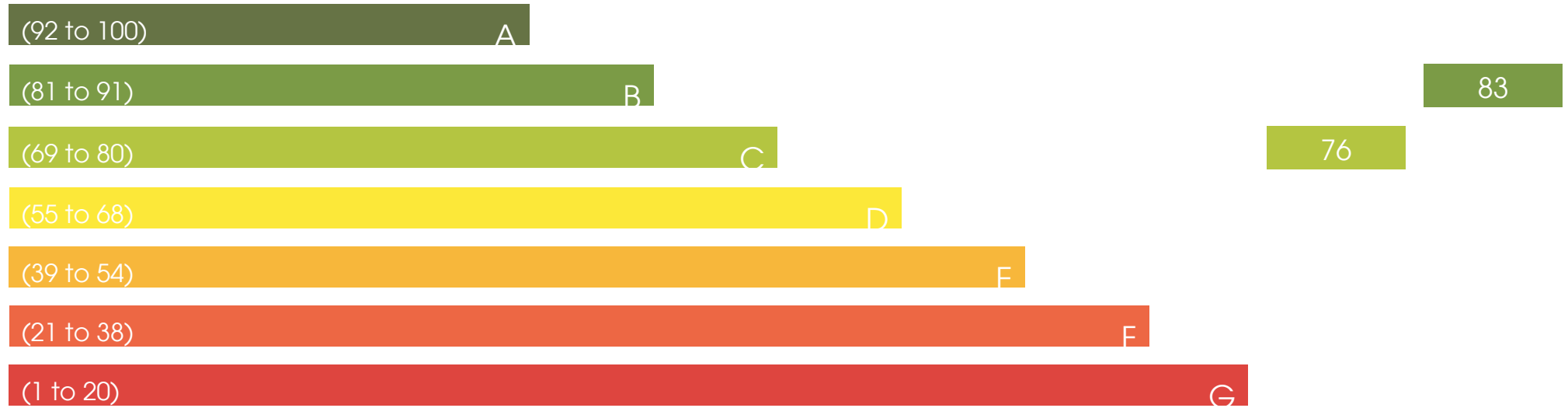

Environmental Impact (CO₂) Rating

Current

Potential

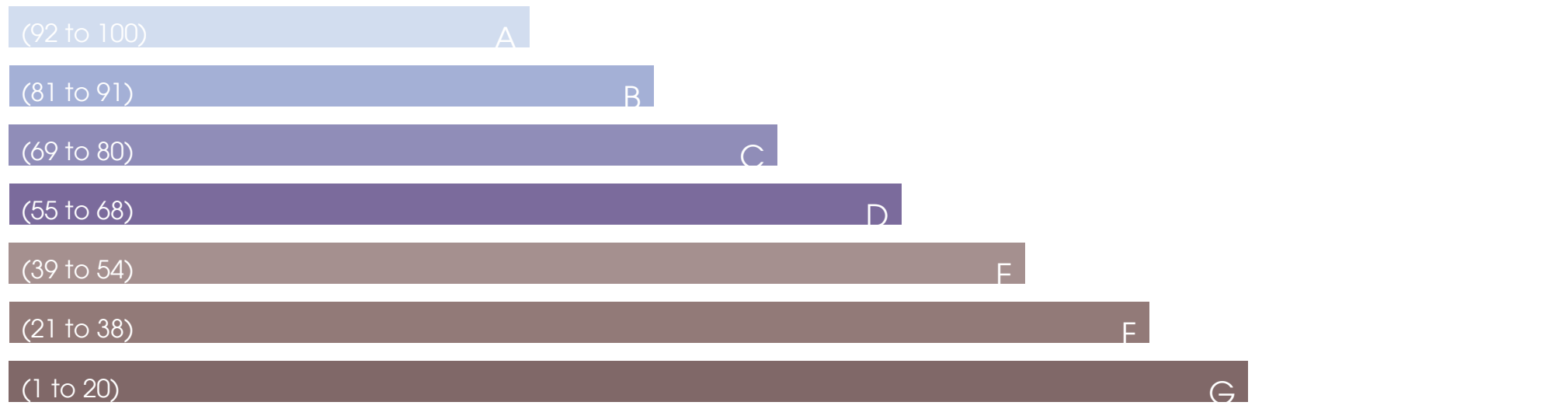

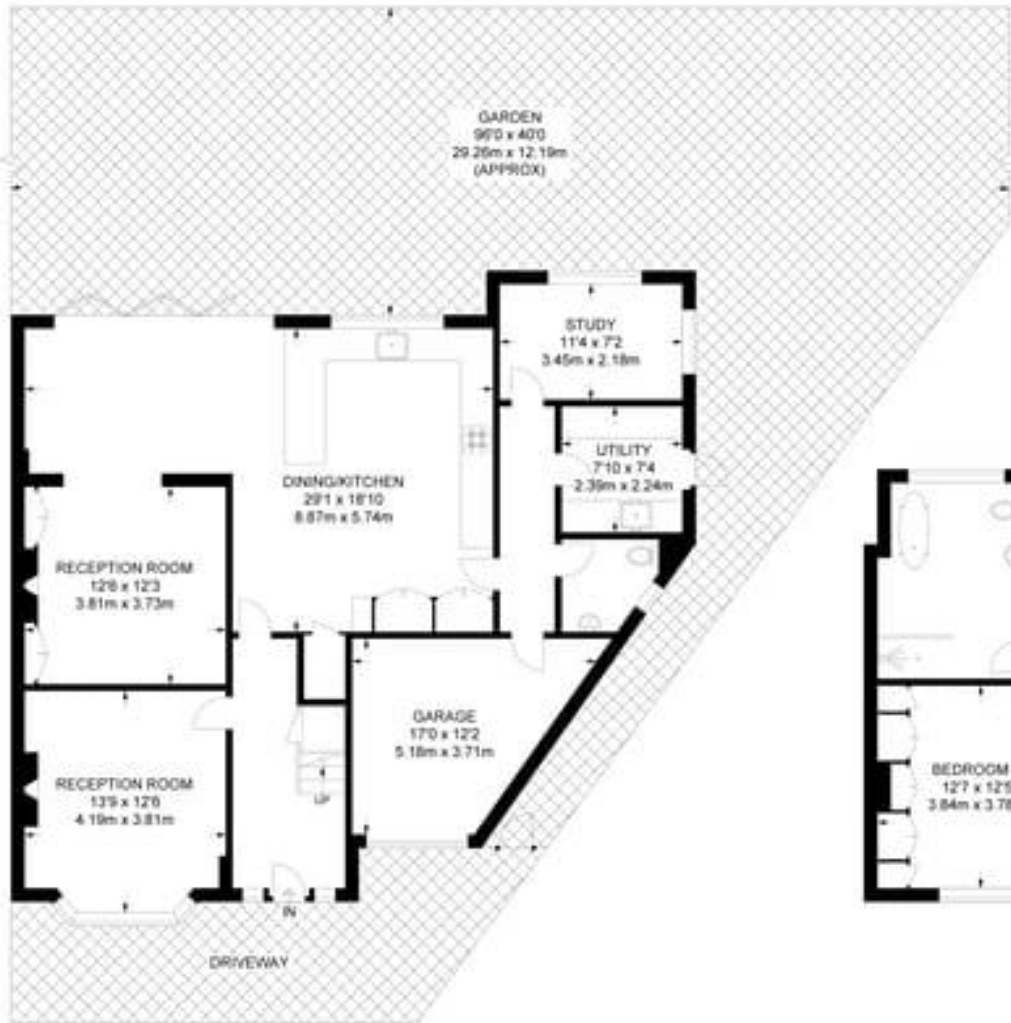

GROUND FLOOR
1275 SQ FT / 118.5 SQ M



FIRST FLOOR
1035 SQ FT / 96.1 SQ M



SECOND FLOOR
770 SQ FT / 71.5 SQ M

APPROXIMATE GROSS INTERNAL AREA
3080 SQ FT / 286.1 SQ M