

## Pickhurst Park, Bromley | £2,500 PCM



With the combination of great schools, excellent transport links, shopping facilities on tap plus a lovely quiet road, this great semi-detached house on the Langley/Bromley borders should be enough to tempt anyone.

Look inside and it should seal the deal. This house is stunning. Very spacious accommodation awaits: three bedrooms upstairs with family bathroom and WC offer better than average square footage, atypical of houses of this era.

Downstairs, the theme continues: a generous reception to the front is just the start.

Venture to the rear of the house and you are greeted with an outstanding family room: a spacious combination of kitchen, dining and living room with bi-folds opening to a sunny rear patio.

There's also a utility room, which in turn opens to the garage.

Stunning 3 bed house to rent in Bromley, unfurnished and available immediately.

NO PETS ARE ALLOWED



## Energy Efficiency Rating

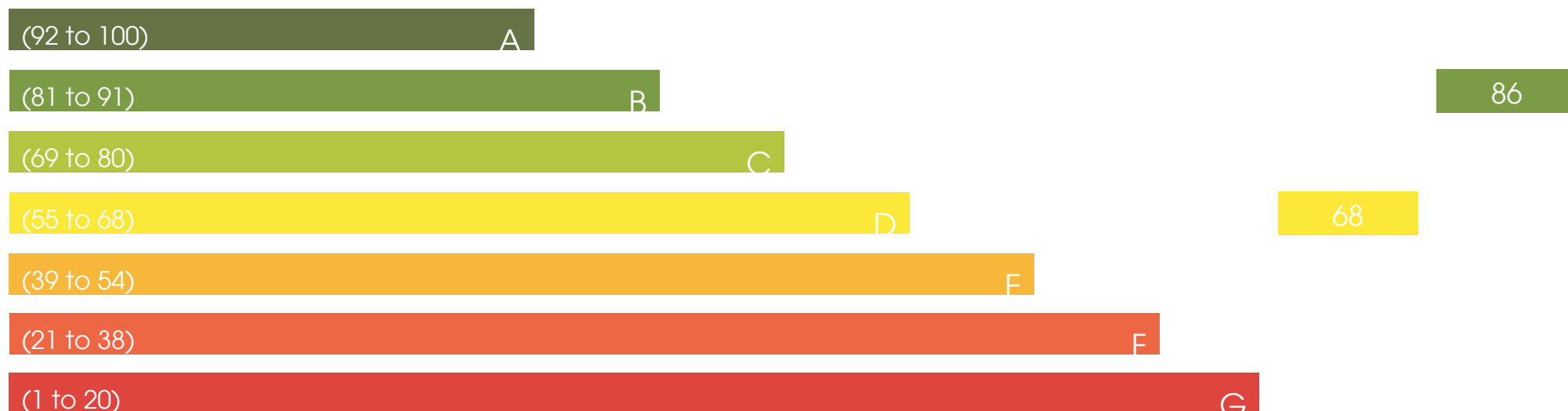

## Enviromental Impact (C0<sub>2</sub>) Rating

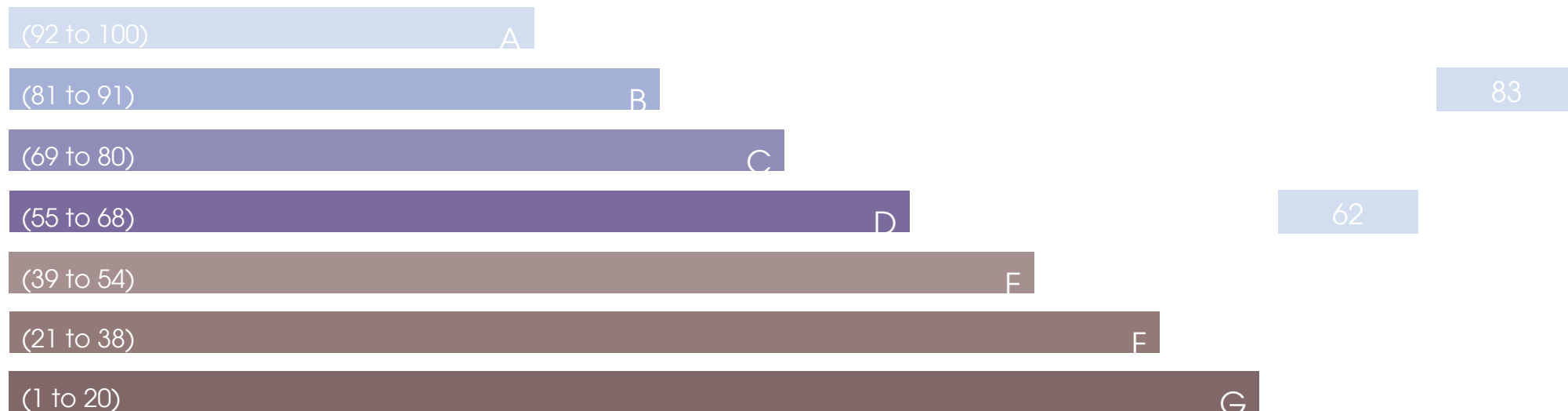



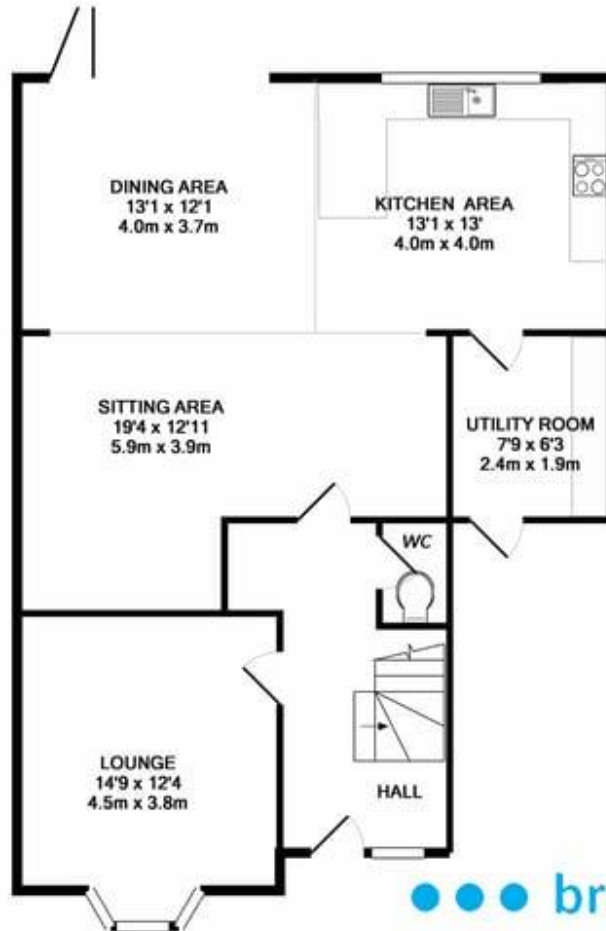

GROUND FLOOR  
APPROX. FLOOR  
AREA 1079 SQ.FT.  
(100.3 SQ.M.)



1ST FLOOR  
APPROX. FLOOR  
AREA 536 SQ.FT.  
(49.8 SQ.M.)



SITE PLAN



● ● ● **bromley property company**

TOTAL APPROX. FLOOR AREA 1615 SQ.FT. (150.1 SQ.M.)

Whilst every attempt has been made to ensure the accuracy of the floor plan contained here, measurements of doors, windows, rooms and any other items are approximate and no responsibility is taken for any error, omission, or mis-statement. This plan is for illustrative purposes only and should be used as such by any prospective purchaser. The services, systems and appliances shown have not been tested and no guarantee as to their operability or efficiency can be given.

Made with Metropix ©2018